

DaeHyup Tech

CRAFTSMANSHIP COVERING YOUR DECK



BILLYTEX A60-L

A60-Class deck covering
(Water Mix Type Self Leveling)



주 | 대 협 테 크
DAEHYUP TECH CO.,LTD.

» Production description

BILLYTEX A60-L is a self leveling type deck composition product for A-60 class deck, which is composed of pelite, cement, hardener, synthetic polymer, etc.
It can be applied for floor and deck in all ship types. It also satisfies IMO FTP code MSC.61(67) Annex 1, part 3 and Annex 2, (IMO Res 754(18) / A799(19)).
The final coating on the BILLYTEX A60-L can be vinyl sheet, tile, carpet, polyurethane or epoxy paint, etc

» Characteristics

- A-60 class deck fire protection
- Excellent thermal protection
- Long life material
- Non-combustibility
- Excellent adhesive component and water-proof without crack
- Impact absorption in collision
- Self leveling property
- Light weight composition

» Application

Area of A-60 class deck, engine room or oil tank area where is required anti-thermal and anti-vibration.

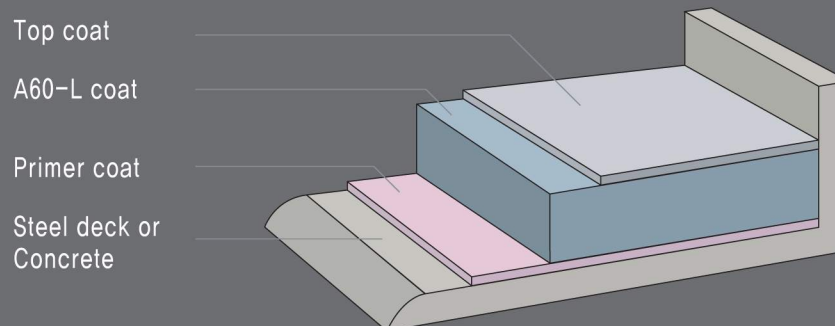

» Certificates

Classification society	CE (MED)	USCG	DNV·GL	BV	LR	ABS	KR	NK	RS
BILLYTEX A60-L	○	○	○	—	—	○	○	—	—

※ ○: Approved, — : Not applicable

>> Installation Steps

1) Pre-treatments

- (1) Eliminate dirt, dust, water & oil.
(Recommend: Use the Vacuum Cleaner)
- (2) If necessary, grinding rust, it's better to eliminate the rust.
- (3) Make sure the steel surface is even.
- (4) Plug the hole or gap below the wall panels.

2) PRIMIR Coat

- (1) The entire content of the hardener is emptied into the base and mixed 2-3 minutes.
Using a power drill.
- (2) One set of PRIMIR consists of:
Base 3kg / Hardener 6kg
(Quantity 112.5M² / 1 set (9kg))
- (3) PRIMIR for corners, welding bead, edge of room and narrow space to be used with a brush; otherwise, an applicable roller can be used.
- (4) After PRIMER coating, the access of the primed surface must be limited for 2 hours in summer & 4 hours in winter. Doors can be open for well ventilation and fast curing.

3) Application for A60-L

- (1) Before applying the A60-L, indicate with a line mark of thickness (Min 25mm) on the wall.
- (2) Pour the water on the mixing bucket in accordance with the mix ratio.

*Recommend of best set ratio

A60-L 2 bags of 15 kg

*Mix ratio

- ▶ Semi-Self leveling → Powder : Water = 2.5 : 1
- ▶ Self leveling → Powder : Water = 2 : 1

- (3) Mixture A60-L must be applied before 30 minutes (+20°C)

4) Application of Heat Bridge Insulation for A60-L installation

- (1) Insulation of Steel wall
 - Store & Etc
 - Installation In Apply with our Spray type Insulation (Spray S 30mm, Density: 140kg/m³) with 450mm, (Attached files of drawing Page 1/2)
- (2) Insulation of Penetrated part
 - Sweat Drain Pipe not necessary to apply.
 - Bottom of Scupper Pipe installation In Deckhead, apply with our Spray type Insulation (Spray S 30mm, Density : 140kg/m³) with 450mm.
 - Penetrated Pipe and bottom of Seat* installation In Deckhead, apply with our Spray type Insulation (Spray S 30mm, Density 140kg/m³) 450mm. (Attached files of drawing Page 2/2)

*Seat : Seats for only equipment such as traction machine for personnel elevator.

5) A60-L Application method.

- (1) Pour the mixed composition to the deck and spread with a trowel to level.
- (2) Do not use or touch with a trowel, when the surface starts curing. (It can cause surface uneven)
- (3) After application of A60-L, the compound must be protected against direct heat and sunlight as well as strong wind. Also it should not be exposed under freezing temperature (Keep the temperature over 5°C)

6) Top coat

BILLYTEX BX-TOP & BX-L103 Double coating is better than one coating to make a good surface.

Curing :

After application of BILLYTEX A60-L, the compound should be protected against direct heat and sunlight as well as strong wind.

Also it should not be exposed under freezing temperature. (Recommended curing temperature is over +5°C)

BILLYTEX A60-L will be cured after approx. 16-24 hours, at +18°C and max. 50% relative humidity; however, the curing time may be variable upon the thickness of the applied layer, temperature, relative humidity and the ventilation of the installed area.

The compound should be completely dry prior to the application of dense finish materials, such as vinyl sheet, stud tile and carpet, etc.
Content of moisture ≤ 6%.

Cleaning

Use water for cleaning tools before the compound is cured

Stock .

- 1) Avoid direct sunlight, also should be kept under cool and low humid condition.
- 2) Seal the remained material tightly after using.
- 3) Don't pile up over 10 bags.
- 4) Avoid from the water while keeping.
Recommend kept on the pallet, not to connect with water.
- 5) A60-L should not be used after expiring the valid date. The available period of 12 months under ordinary conditions is guaranteed.

BILLYTEX A60-L



Priming steel deck



Mixing



Application A60-L

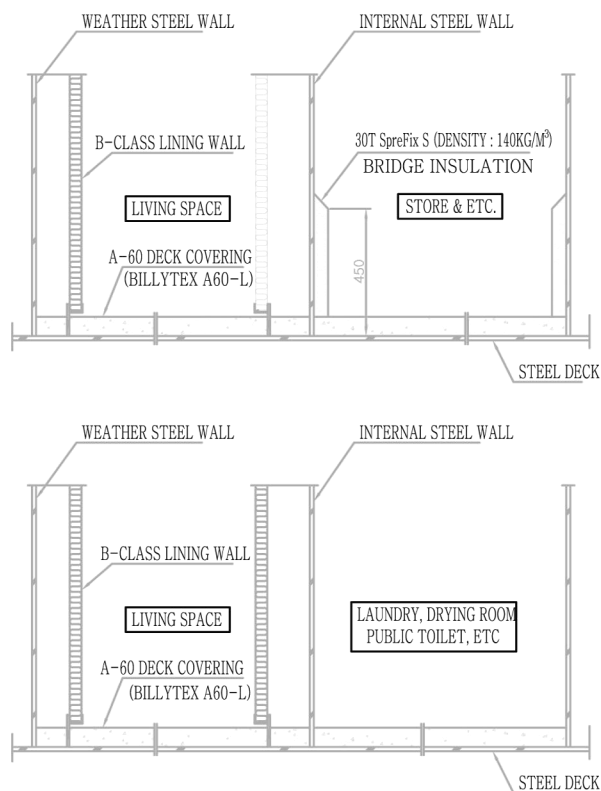
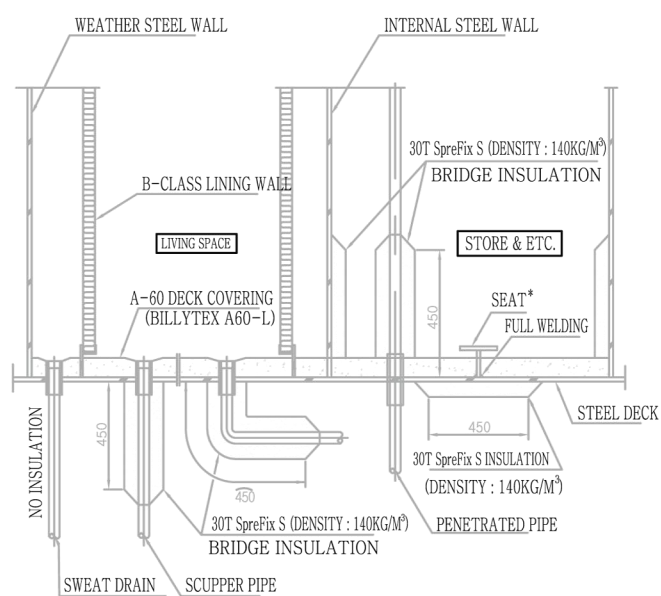

Finnished application

APPLICATION OF HEAT BRIDGE FOR
INSULATION OF STEEL WALLAPPLICATION OF HEAT BRIDGE INSULATION FOR
STEEL WALL, PENETRATED PIPE, ETC.

SEAT* : SEATS FOR ONLY EQUIPMENT SUCH AS TRACTION MACHINE
FOR PERSONNEL ELEVATOR

BILLYTEX A60-L – A60-Class deck covering (Water Mix Type Self Leveling)

>> Technical data

Basis :	Perlite and Cement
Color :	White, Grey
Density (g/cm ³) :	Approx. 0.96 (applied)
Compressive Strength (MPa):	27.4
Tensile Strength (MPa):	4.3
Heat conductivity (W/m·K)	0.073
Flexural Strength (MPa):	7.5
Fire resistance:	Fire resistant
Thickness (mm):	25
Curing time (hourse):	16-24
Sound Reduction:	RW:41dB

>> Application method

Process		Materials	Unit	Quantity(m²)	Thickness
A60-L coat	Semi self leveling	A-60L Powder	Kg	24	25mm
		Water	Kg	9.6	
	Self leveling	A-60L Powder	Kg	24	
		Water	Kg	12	
Top coat		BX-Top	Kg	0.9	0.5mm
		BX-L 103	Kg	0.3	

1) A60-L 1 Set is Powder 15kg/Bag.

2) The practical consumption of 1 Set (15kg/Bag) 15.7 mm/m², depends on the fairing condition of foundation.

3) Standard thickness Min. 25mm

4) The ratio of mixture with water can be differ depends on weather (Winter & Summer).

DAEHYUP TECH Co., Ltd. provides a complete range of marine deck covering products such as powder, latex, epoxy and urethane types.

We have been developing our products more than two decades through various experience in manufacturing and installations.

The quality of our products is assured by ISO 9001:2000 and approved by major authorities including leading classification societies in compliance with the IMO rules.

DaeHyup Tech

CRAFTSMANSHIP COVERING YOUR DECK



88, Janggiteo 2-gil, Ungchon-myeon, Uiju-gun, Ulsan, Republic of Korea

TEL: +82-52-277-9110-3

FAX: +82-52-277-9114-5

E-mail: daehyup@dae-hyup.com

www.dae-hyup.com